

Please read these instructions before installing, as incorrect fitting will invalidate the guarantee-carry out each stage before moving onto the next.

If you are unsure about these instructions please contact Kudos Shower Products:

Customer Service Helpline: 01539 564040

TOOLS REQUIRED

- 1) Flat Headed Screwdriver
- 2) Pozi-Drive Screwdriver
- 3) Spirit Level
- 4) Tape Measure
- 5) Silicone Sealant
- 6) Electric Drill
- 7) 7mm Drill Bit (Masonry)
- 8) 2mm Allen key - included



IMPORTANT

- **Check appearance of shower enclosure.** Any defects must be reported to Kudos Shower Products before assembly / installation. Claims for imperfections will only be accepted prior to assembly / installation
- Ensure shower tray is level in **all** directions
- **Prior to installation**, any gap or crevice between the rim of the tray and wall **must** be filled with silicone sealant flush with the rim of the tray - see detail opp.
- Waterproof walls using ceramic tiles/shower panels etc., **before** installing shower enclosure
- Check the enclosure adjustment sizes are suitable for your installation
- Care should be taken when drilling into walls to avoid hidden pipes or electrical cables

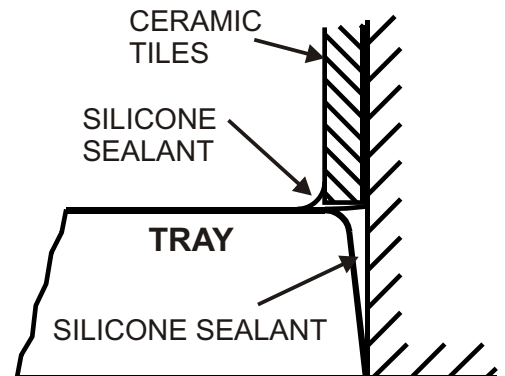

CLEANING

GENERAL- use only warm soapy water and damp cloth/sponge on a regular basis.

Do not use abrasive scouring powders, chemicals or aerosol cleaners- these may result in damage to the surfaces, in particular, the plated component parts

THESE INSTRUCTIONS ARE TO BE LEFT WITH THE USER

If you are installing a side panel together with this door, please read these instructions in conjunction with the instructions for the side panel provided in the side panel packing.

- 1 Determine whether door is to be left or right opening. This will then identify which is the top of the door, (the door can be installed either way up and this establishes whether the door is to be left or right hand opening).

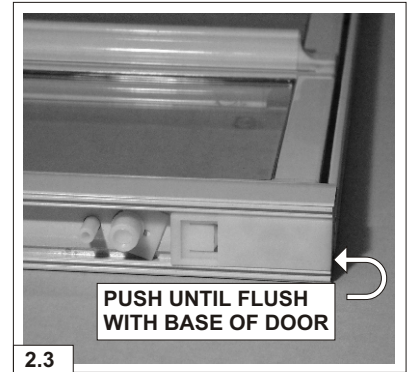
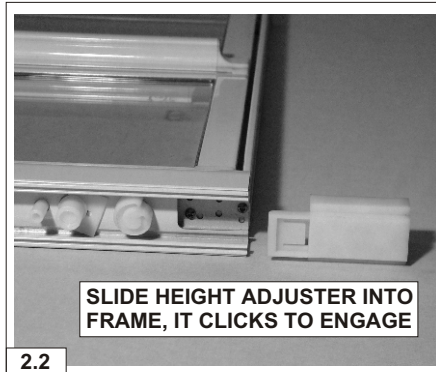
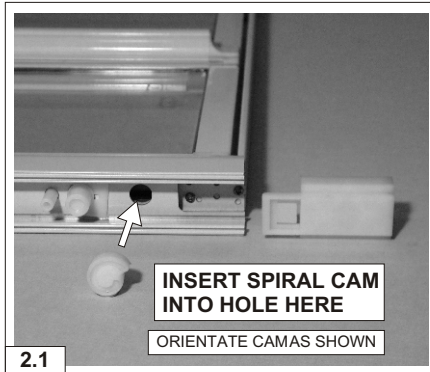

- 2 Lay the door flat on a protective surface, with the inside face of the door facing upwards. Insert height adjusters into bottom of compensating channel / wall frames at bottom of door as shown in *fig. 2.1, 2.2 & 2.3*. First insert spiral cam as shown in *fig.2.1* into both lower sides of frame, next slide height adjuster into both sides of frame and over spiral cam *fig.2.2* ensure height adjuster "clicks" into spiral cam as it engages and is fully inserted *fig. 2.3*

- 3 Raise door panels by lifting the centre handle, the side which remains hinged at the door frame may be released by pulling the glass panel away from the frame, it is only held by a clipping action. Place some support such as a few books to keep the door panels away from the door frame *Fig. 3.1* thereby giving easy access to the clip-in extrusions at the inner sides of the door frame.

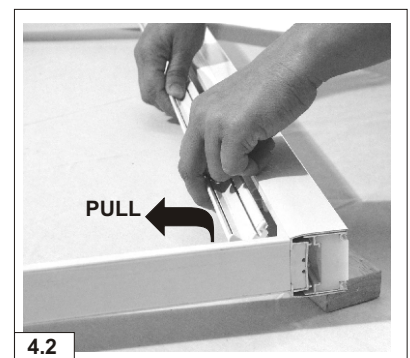
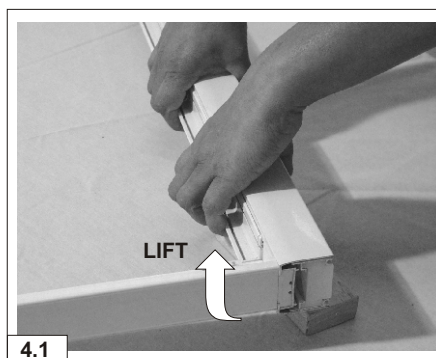
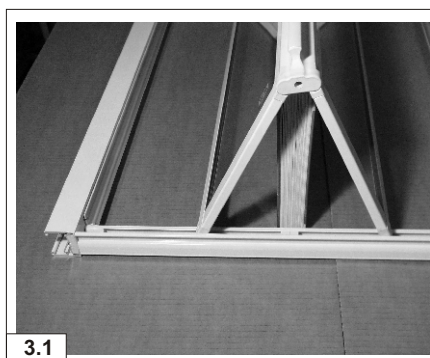

- 4 Remove clip-in extrusions on both sides as shown in *figs. 4.1, 4.2*

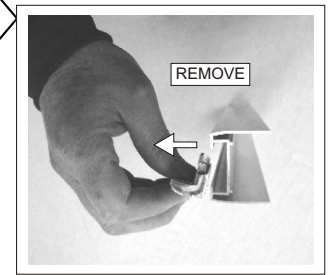
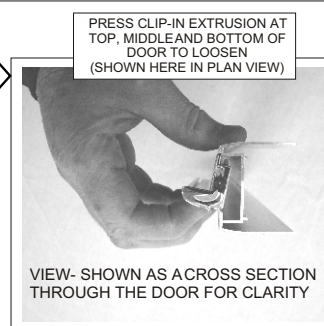

- ⑤ Offer frame into opening and expand door width equally on both sides by turning the nylon adjustment screws - 3 at each side of the door - in an anti-clockwise direction. Only tighten until door is lightly wedged in position. *Fig. 5*
- ⑥ Set door level on tray by turning relevant height adjuster screw (clockwise to raise) if necessary. Use a spirit level to ensure accurate leveling. *Fig. 6.1 and 6.2*

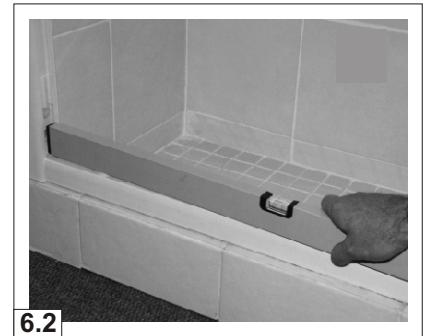
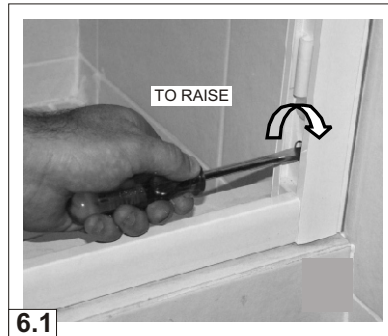
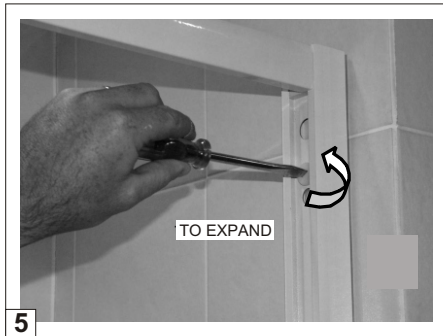

- ⑦ Mark holes through wall frames of door - 3 each side. Remove door and drill holes in wall using 7mm masonry drill bit. *Fig. 7.* Useful tip: For accuracy, to mark holes through wall frames dip a drill bit in nail polish and "spot" the position through the wall frame mouldings. *Fig. 7.1*

- ⑧ Insert wall plugs provided or fixings to suit the construction of your walls (below tiles to avoid cracking) *Fig. 8* and offer door into position. Check the door frame is level, vertical and square on all sides of the opening, checking to ensure the door is not leaning forward or backwards in the opening. *Fig. 8.1.* Frame **MUST NOT** be twisted or buckled when fitting. Adjust the door ensuring frame is vertical, if necessary, using the adjustment screws as per stage 5 and **GENTLY** tighten frame into opening ensuring sides of door frame are not distorted by over-tightening. Fix door using 6 x No.8 Panhead 60mm screws provided. The middle screws may now be adjusted to assist in plumbing the door frame. Be sure not to over tighten the middle screws (finger tighten only) as this may cause "bowing" of the door frame.

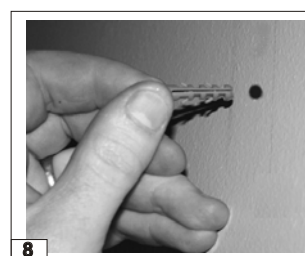
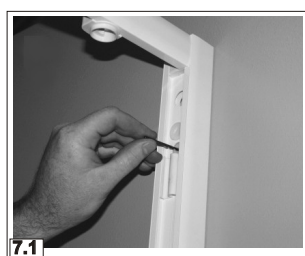
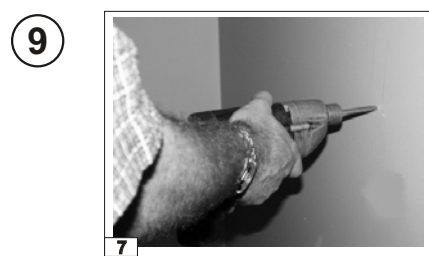

Re-fit clip-in extrusions, which were removed in stage 4. Ensure the leading edge is properly located along full height before pressing the clip-in extrusion into the door frame, it will not locate properly if twisted. *Fig. 9*

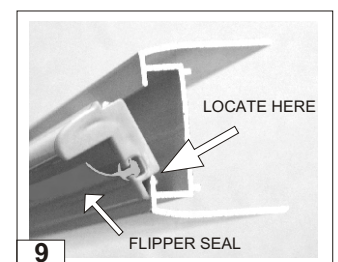

View shown as cross section through door for clarity

- ⑩ Check closing action of door. Door closing action is magnetic and the two panels should "snap" into the closed position. If the panels tend to spring back slightly open, check the tension on the adjustment screws in stage 8 above as over tightening can "bow" the door frame and put tension on the panels.

- ⑪ Fit compensating channel caps and door frame top caps, the latter being screwed into place with 10mm long screws provided. *Figs. 11.1 & 11.2*

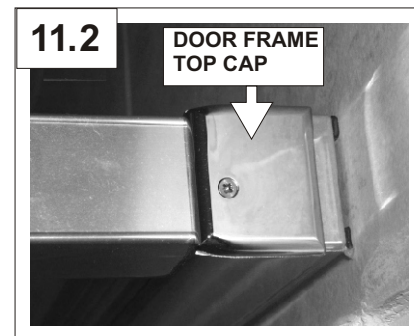
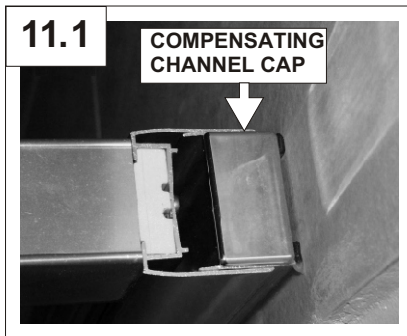

- ⑫ Silicone seal around edges of door and at junction of lower sill to wall jambs on outer face. **Allow 24 hours before using shower.**

- a) Both vertical junctions of frame to wall on OUTSIDE and INSIDE. *Fig 12.1*
- b) Junction of lower sill to wall jamb on OUTSIDE only. *Fig 12.2*
- c) Bottom edge of lower sill to tray on OUTSIDE only. *Fig 12.3*

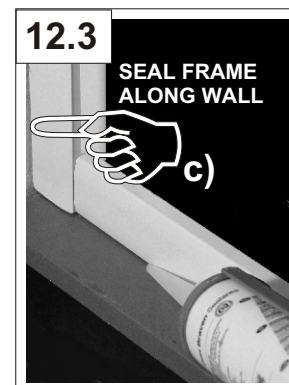
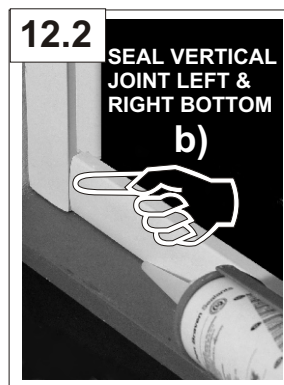
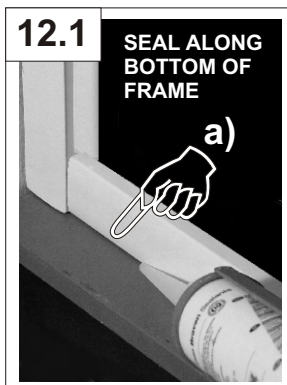

Do not silicone seal on the inside of unit (except where shown). Sealing the wallposts & sills to the tray on the inside can result in leakage problems- please note that, in use, water can penetrate into the frame extrusions- *this has no detrimental effect to the product*- however, this water must be allowed to drain out of the extrusions to the inside.

- ⑬ **Centre magnet holder mouldings -**

These are situated in the top & bottom sills and can be repositioned, if necessary, to align with door centre-hinge mouldings, by using the 2mm allen key provided.

- Ⓝ **Cleaning -** door can be un-clipped at pivot side for cleaning purposes by lightly pulling door towards centre of frame at both top and bottom. After cleaning, simply push back to re-engage.